

PARKING STANDS AND TAXIING ON APRON NORTH PRAHA/Ruzyně

AIP
CZECH REPUBLIC

LKPR AD 2-21-1
1 JUN 04

APRON ELEV
1174 ft/358 m

DELIVERY	120,050
GROUND	121,900
APRON	131,950

AIRCRAFT PARKING/ DOCKING CHART - ICAO PRAHA/Ruzyně

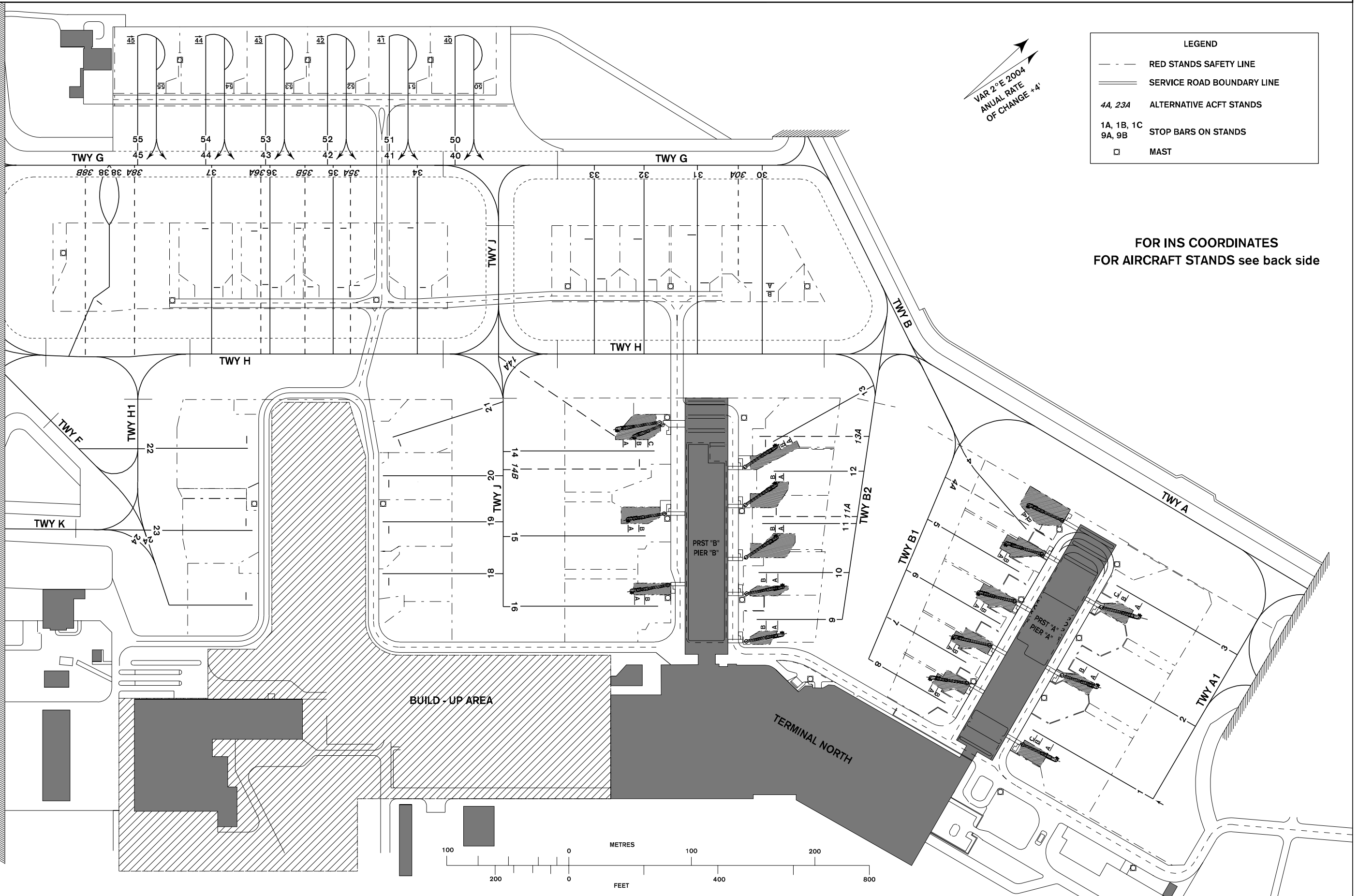

LEGEND

- RED STANDS SAFETY LINE
- SERVICE ROAD BOUNDARY LINE
- 4A, 23A ALTERNATIVE ACFT STANDS
- 1A, 1B, 1C STOP BARS ON STANDS
- 9A, 9B
- MAST

FOR INS COORDINATES
FOR AIRCRAFT STANDS see back side

change: new centre-line markings TWY G and TWY J, lighting masts by PIER C



INS COORDINATES FOR AIRCRAFT STANDS	
1A	50°06'35,60"N 14°16'11,38"E
1B	50°06'35,47"N 14°16'10,94"E
1C	50°06'35,40"N 14°16'10,72"E
2A	50°06'37,58"N 14°16'10,03"E
2B	50°06'37,44"N 14°16'09,57"E
3A	50°06'39,53"N 14°16'08,70"E
3B	50°06'39,37"N 14°16'08,14"E
3C	50°06'39,27"N 14°16'07,85"E
4A	50°06'38,14"N 14°16'03,18"E
4B	50°06'38,15"N 14°16'03,31"E
4A	<i>50°06'38,39"N 14°16'04,06"E</i>
5A	50°06'37,14"N 14°16'04,15"E
5B	50°06'37,19"N 14°16'04,29"E
6A	50°06'35,96"N 14°16'05,15"E
6B	50°06'36,04"N 14°16'05,42"E
7A	50°06'34,80"N 14°16'06,09"E
7B	50°06'34,84"N 14°16'06,23"E
8A	50°06'33,74"N 14°16'07,08"E
8B	50°06'33,80"N 14°16'07,28"E
9A	50°06'31,37"N 14°16'00,95"E
9B	50°06'31,48"N 14°16'01,06"E
10A	50°06'32,17"N 14°15'59,49"E
10B	50°06'32,32"N 14°15'59,64"E
11A	50°06'32,95"N 14°15'57,85"E
11B	50°06'32,77"N 14°15'57,66"E
11A	<i>50°06'32,95"N 14°15'57,48"E</i>
12A	50°06'33,80"N 14°15'56,27"E
12B	50°06'33,73"N 14°15'56,20"E
13A	50°06'34,37"N 14°15'55,16"E
13B	50°06'34,18"N 14°15'55,14"E
13A	<i>50°06'33,95"N 14°15'54,79"E</i>
14A	50°06'30,82"N 14°15'52,12"E
14B	50°06'31,09"N 14°15'52,41"E
14C	50°06'31,32"N 14°15'52,65"E
14A	<i>50°06'30,80"N 14°15'51,19"E</i>
14B	<i>50°06'30,89"N 14°15'53,07"E</i>
15A	50°06'29,73"N 14°15'54,99"E
15B	50°06'29,94"N 14°15'55,20"E
16A	50°06'28,68"N 14°15'57,49"E
16B	50°06'28,81"N 14°15'57,63"E
18	50°06'24,00"N 14°15'50,87"E
19	50°06'24,75"N 14°15'49,17"E
20	50°06'25,44"N 14°15'47,61"E
21	50°06'26,17"N 14°15'46,45"E
22	50°06'22,73"N 14°15'43,44"E
23	50°06'21,52"N 14°15'46,18"E
24	50°06'20,43"N 14°15'48,65"E
30A	50°06'36,23"N 14°15'49,60"E
30B	50°06'36,10"N 14°15'49,90"E
30A	<i>50°06'35,72"N 14°15'49,05"E</i>
31	50°06'34,92"N 14°15'48,09"E
32	50°06'33,85"N 14°15'46,73"E
33	50°06'32,84"N 14°15'45,65"E
34	50°06'28,92"N 14°15'41,62"E
35	50°06'27,11"N 14°15'39,68"E
35A	<i>50°06'27,44"N 14°15'40,04"E</i>
35B	<i>50°06'26,43"N 14°15'38,96"E</i>
36	50°06'25,57"N 14°15'38,04"E
36A	<i>50°06'25,35"N 14°15'37,81"E</i>
37	50°06'24,25"N 14°15'36,64"E
38	50°06'21,54"N 14°15'34,80"E
38A	<i>50°06'22,49"N 14°15'35,30"E</i>
38B	<i>50°06'21,47"N 14°15'34,22"E</i>

INS COORDINATES FOR AIRCRAFT STANDS	
40	50°06'33,16"N 14°15'34,84"E
41	50°06'31,73"N 14°15'33,31"E
42	50°06'30,35"N 14°15'31,83"E
43	50°06'28,91"N 14°15'30,30"E
44	50°06'27,53"N 14°15'28,83"E
45	50°06'26,10"N 14°15'27,29"E
50	50°06'32,97"N 14°15'36,51"E
51	50°06'31,54"N 14°15'34,97"E
52	50°06'30,15"N 14°15'33,50"E
53	50°06'28,72"N 14°15'31,96"E
54	50°06'27,34"N 14°15'30,49"E
55	50°06'25,90"N 14°15'28,96"E